

THROUGH CONNECTORS

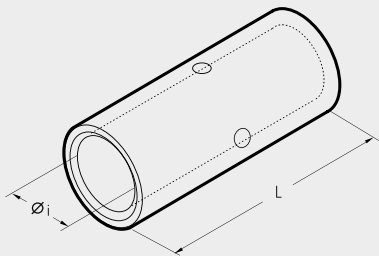

File no. E125401



Conductor Size sqmm		Ref.	Dimensions mm		Quantity Box/Bag	Mechanical Tools	Hydraulic Tools
low stranded	Flexible		Øi	L			
0,25÷1,5	0,25÷1,5	L 03-M*	1,8	15	6.000/100		
1,5÷2,5	1,5÷2,5	L 06-M*	2,4	15	4.000/100	HN 1	
4÷6	4÷6	L 1-M*	3,6	22	2.000/100	HN 5	
10	10	L 2-M	4,6	25	1.000/100	HN A25	
16	16	L 3-M	5,8	27	1.000/100	TN 70 SE	
25	25	L 5-M	7,0	29	500/100	TN 120 SE*	B 15MDE
35	25÷35	L 7-M	8,9	33	400/100		B 35-45MDE
50	35÷50	L 10-M	10,0	37	200/50		B 35-50MDE
70	50÷70	L 14-M	11,3	39	200/50		HT 45-E
95	70÷95	L 19-M	13,5	43	100/25		HT 51 B 550E
120	95÷120	L 24-M	15,2	47	100/25		RH 50 B 500E
150	120÷150	L 30-M	16,7	58	50/25		HT 81-U RHU 81
185	150÷185	L 37-M	19,2	64	50/25		HT 120 and tools and heads with 130 kN crimping force
240	185÷240	L 48-M	21,1	75	30/15		ECW-H3D
300	240÷300	L 60-M	23,7	90	20/10		RHU 520
400	300÷400	L 80-M	27,0	94	20/5		
500	400÷500	L 100-M	30,3	98	12/1		
630	500÷630	L 120-M*	33,4	105	12/1		
800	600	L 160-M*	38,0	112	9/1		
1000	800	L 200-M*	44,0	120	6/1		

*See page 111

♦Not UL approved

L-M



L-M range of connectors are designed for jointing low voltage conductors. Made of electrolytic Copper tube having the same dimension as A-M series lugs: L-M connectors are annealed and electrolytically Tin plated.

They feature an internal taper at both ends to ease the introduction of the conductor and a central stop to ensure correct positioning.

Details of the appropriate crimping tools and dies are shown on pages 178 to 179.

PARALLEL CONNECTORS

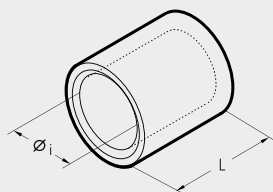

Total Conductor Size sqmm		Ref.	Dimensions mm		Quantity Box/Bag	Mechanical Tools	Hydraulic Tools
low stranded	Flexible		Øi	L			
0,25÷1,5	0,25÷1,5	L 03-P	1,8	6,0	10.000/100		
1,5÷2,5	1,5÷2,5	L 06-P	2,4	6,0	5.000/100	HN 1	
4÷6	4÷6	L 1-P	3,6	9,0	3.000/100	HN 5	
10	10	L 2-P	4,6	10,5	3.000/100	HN A25	
16	16	L 3-P	5,8	11,5	2.000/100	TN 70 SE	
25	25	L 5-P	7,0	13,0	1.500/100	TN 120 SE*	B 15MDE
35	25÷35	L 7-P	8,9	14,0	500/100		B 35-45MDE
50	35÷50	L 10-P	10,0	16,0	500/100		B 35-50MDE
70	50÷70	L 14-P	11,3	18,0	500/100		HT 45-E
95	70÷95	L 19-P	13,5	19,0	300/50		HT 51 B 550E
120	95÷120	L 24-P	15,2	22,0	200/50		RH 50 B 500E
150	120÷150	L 30-P	16,7	26,5	100/50		HT 81-U RHU 81
185	150÷185	L 37-P	19,2	26,5	100/50		HT 120 and tools and heads with 130 kN crimping force
240	185÷240	L 48-P	21,1	34,0	60/15		ECW-H3D
300	240÷300	L 60-P	23,7	43,0	50/25		RHU 520

*See page 111

L-P



Made of electrolytic Copper tube, having the same dimensions as A-M series lugs, L-P connectors are annealed and electrolytically Tin plated.

They feature an internal taper to ease the introduction of the conductor.

Details of the appropriate crimping tools and dies are shown on pages 178 to 179.