

Panel mounted socket
Part no. 740



- screw terminals
- highly heat resistant contact carrier
- nickel plated contacts
- 20° inclination
- sockets optional fitted with auxiliary contact

Technical specifications

| | |
|---------------------------|---|
| Ampere | 32 A |
| Poles | 7 p |
| Voltage | 400 V |
| Clock position | 6 h |
| Hertz | 50-60 Hz |
| Connection technology | Screw terminals |
| Contact | highly heat resistant contact carrier, nickel plated contacts |
| Protection type | IP 44 |
| Flange | 100x92 mm |
| Fixing hole | 85x77 mm |
| Inclination | 20 ° |
| Weight | 300 g |
| Declaration of Conformity | CN,CQC |

Drawing

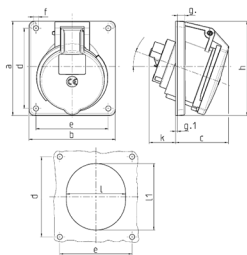

| Drawing | Amp. | 16 | 32 |
|--------------------------|-------|-----|-----|
| 1 MB 260 | Poles | 7 | 7 |
| Dim. in mm | a | 100 | 100 |
| | b | 92 | 92 |
| | c | 58 | 61 |
| | d | 85 | 85 |
| | e | 77 | 77 |
| | f | 5.5 | 5.5 |
| | g | 8 | 8 |
| | g-1 | 2 | 2 |
| | h | 100 | 106 |
| | k | 40 | 55 |
| | l | 65 | 72 |
| | l1 | 72 | 85 |
| | α | 20° | 20° |
| Terminal for cond. cross | | 1.5 | 2.5 |
| section (mm²) min.-max. | | —4 | —10 |