

2A-M

HEAVY DUTY COPPER TUBE TERMINALS TYPE 2A-M

for copper conductors

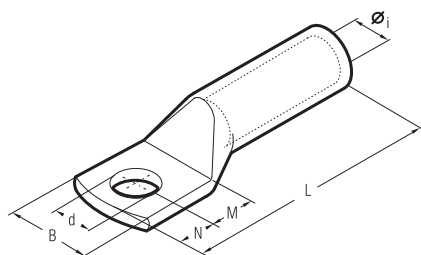

Features

- Serie 2A-M terminals is designed for medium voltage application up to 35 kV
- They feature a double length barrel for enhanced electrical and mechanical performance in heavy duty applications.
- Cembre lugs are annealed to guarantee optimum ductility which is an absolute necessity for connectors which will have to withstand the severe deformation arising when compressed and any bending of the palm during installation.
- In applications subject to vibration, terminals still have to perform a reliable connection, annealing plays a vital role in avoiding cracking or breaks between the barrel and palm.
- The absence of an inspection hole prevents the entry of water or moisture into the crimped joint making these terminals suitable for outdoor applications.
- 2A-M series lugs form an important part of Cembre crimping systems for power carrying conductors.
- Each connector is marked as follows: Cembre trade mark and reference number, Nature and size of conductor (sqmm), Ø stud (mm).

Conductor Size sqmm	Ø Stud mm	Type	Dimensions mm					
			Øi	B	M	N	L	d
16	8	2A3-M8	5,8	15,0	9,0	8,0	43,5	8,4
	10	2A3-M10	5,8	18,0	11,0	10,0	47,5	10,5
25	8	2A5-M8	7,0	15,0	9,0	8,0	51,0	8,4
	10	2A5-M10	7,0	18,0	11,0	10,0	55,0	10,5
35	12	2A5-M12	7,0	21,0	14,0	12,0	60,0	13,2
	8	2A7-M8	8,9	17,0	9,0	8,0	53,0	8,4
50	10	2A7-M10	8,9	19,0	11,0	10,0	57,0	10,5
	12	2A7-M12	8,9	21,0	14,0	12,0	62,0	13,2
63	10	2A10-M10	10,0	20,0	11,0	10,0	63,0	10,5
	12	2A10-M12	10,0	21,0	14,0	12,0	68,0	13,2
70	14	2A10-M14	10,0	25,0	16,0	14,0	72,0	15,0
	16	2A10-M16	10,0	26,0	18,0	16,0	76,0	17,0
95	10	2A14-M10	11,3	21,0	11,0	10,0	70,0	10,5
	12	2A14-M12	11,3	22,0	14,0	12,0	75,0	13,2
120	14	2A14-M14	11,3	25,0	16,0	14,0	79,0	15,0
	16	2A14-M16	11,3	26,0	18,0	16,0	83,0	17,0
125	10	2A19-M10	13,5	25,0	11,0	10,0	76,5	10,5
	12	2A19-M12	13,5	25,0	14,0	12,0	81,5	13,2
150	14	2A19-M14	13,5	25,0	16,0	14,0	85,5	15,0
	16	2A19-M16	13,5	27,0	18,0	16,0	90,5	17,0
185	20	2A19-M20	13,5	29,5	22,0	20,0	97,5	21,0
	10	2A24-M10	15,2	28,5	11,0	10,0	82,0	10,5
240	12	2A24-M12	15,2	28,5	14,0	12,0	87,0	13,2
	14	2A24-M14	15,2	28,5	16,0	14,0	91,0	15,0
300	16	2A24-M16	15,2	28,5	18,0	16,0	95,0	17,0
	20	2A24-M20	15,2	30,0	22,0	20,0	103,0	21,0
330	10	2A30-M10	16,7	31,5	13,0	11,0	92,0	10,5
	12	2A30-M12	16,7	31,5	16,0	14,0	98,0	13,2
375	14	2A30-M14	16,7	31,5	18,0	16,0	102,0	15,0
	16	2A30-M16	16,7	31,5	19,0	17,0	104,0	17,0
420	20	2A30-M20	16,7	31,5	22,0	20,0	110,0	21,0
	12	2A37-M12	19,2	35,5	16,0	14,0	108,0	13,2
480	14	2A37-M14	19,2	35,5	18,0	16,0	112,0	15,0
	16	2A37-M16	19,2	35,5	19,0	17,0	114,0	17,0
540	20	2A37-M20	19,2	35,5	22,0	20,0	120,0	21,0
	12	2A48-M12	21,1	39,0	16,0	14,0	109,0	13,2
600	14	2A48-M14	21,1	39,0	18,0	16,0	113,0	15,0
	16	2A48-M16	21,1	39,0	19,0	17,0	115,0	17,0
675	20	2A48-M20	21,1	39,0	22,0	20,0	121,0	21,0
	12	2A60-M12	23,7	44,0	20,0	14,0	129,5	13,2
750	14	2A60-M14	23,7	44,0	22,0	16,0	133,5	15,0
	16	2A60-M16	23,7	44,0	22,0	19,0	136,5	17,0
825	20	2A60-M20	23,7	44,0	24,0	23,0	142,5	21,0
	12	2A80-M12	27,0	51,0	22,0	19,0	140,0	13,2
900	14	2A80-M14	27,0	51,0	22,0	19,0	140,0	15,0
	16	2A80-M16	27,0	51,0	22,0	19,0	140,0	17,0
975	20	2A80-M20	27,0	51,0	24,0	23,0	146,0	21,0
	16	2A100-M16*	30,3	56,5	22,0	19,0	141,0	17,0
1050	20	2A100-M20*	30,3	56,5	24,0	23,0	147,0	21,0
	16	2A120-M16*	33,4	61,5	22,0	19,0	159,0	17,0
1125	20	2A120-M20*	33,4	61,5	24,0	23,0	165,0	21,0
	20	2A160-M20*	38,0	72,0	24,0	23,0	187,0	21,0
1200	20	2A200-M20*	44,0	80,0	24,0	23,0	202,0	21,0

*NOT UL APPROVED

Materials

- Lugs are manufactured from electrolytic copper tube Cu-OF CW008A conforming to UNI EN 13600:2013.
- Lugs are electrolytically tin plated with a minimum thickness of 3µm to avoid oxidation.

Markings



- According to UL 486A standard (file E125401)

Cembre SpA

Via Serenissima, 9 • 25135 Brescia (Italy)
Tel. +39 030 36921 • Fax +39 030 3365766
cembre.com • info@cembre.com

PDS A8
08/10/2020
Issued from Marketing Dept.