

D14F-2Z-C3-N



■ performance parameters

Rated voltage : 300VAC
 Rated current : 10A (2 x 5A)
 Insulation voltage : ≥ 3KV
 Socket material : PA46-S250F6 (V1/V0)
 Contacts spring material : QSn6.5-0.1
 Hold down spring (on request) : Steel wire - various, see Page 25
 Ejector clip : Various depending on relay type - see Page 25
 Module : see Pages 21-23

■ outline drawing

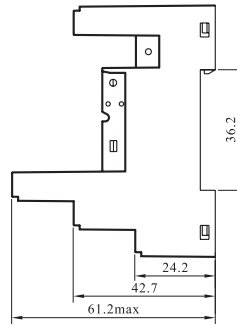
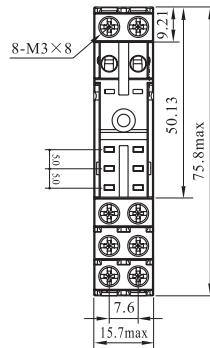

■ wiring diagram

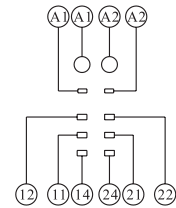

	parameters	outline drawing	wiring diagram
<p>D14F-1Z-A1</p>	<p>Rated voltage : 300VAC Rated current : 10A Insulation voltage : ≥ 3KV Socket material : PA46-S250F6 (V1/V0) Contacts spring material : QSn6.5-0.1</p> <p>Hold down spring (on request) : Steel wire - various, see Page 25</p>		
<p>D14F-1Z-A2</p>	<p>Rated voltage : 300VAC Rated current : 10A Insulation voltage : ≥ 3KV Socket material : PA66+GF (V1/V0) Contacts spring material : QSn6.5-0.1</p> <p>Hold down spring (on request) : Steel wire - various, see Page 25</p>		
<p>D14F-1Z-C2</p>	<p>Rated voltage : 300VAC Rated current : 10A Insulation voltage : ≥ 3KV Socket material : PA66+GF (V1/V0) Contacts spring material : QSn6.5-0.1</p> <p>Hold down spring (on request) : Steel wire - various, see Page 25</p> <p>Ejector clip : Various, depending on relay type - see Page 25</p> <p>Module : see Pages 21-23</p>		