

# ISO-TP LOW VOLTAGE INSULATORS, METRIC THREAD



## CERTIFICATIONS



## FEATURES

Halogen free

High resistance to leakage current

Great stability of electrical and mechanical parameters

Fiberglass reinforced

UL® Recognized in E125470 and evaluated for dielectric withstand rating of 1,500 VAC/DC

RoHS compliant

## SPECIFICATIONS

<b>Dielectric Strength, UL:</b>	1,500 VAC/DC
<b>Finish:</b>	Electrogalvanized
<b>Material:</b>	Steel;Glass Fibre Reinforced Polyamide
<b>Complies With:</b>	IEC® 60695-2-11 (Glow Wire Test 960 °C)
<b>Flammability Rating:</b>	UL® 94V-0
<b>Working Temperature:</b>	-40 to 130 °C

Table 1/2

Catalog Number	Item Name	Insulation Voltage	Dielectric Strength, IEC 61439.1	Height(H)	Hex Width(W)	Depth(D)
ISOTP15M4	548400	500 VAC, 500 VDC	2,500 VAC @ 1 min	15 mm	14 mm	16 mm
ISOTP20M4	548410	1,000 VAC, 1,500 VDC	3,500 VAC @ 1 min	20 mm	17 mm	20 mm

Catalog Number	Item Name	Insulation Voltage	Dielectric Strength, IEC 61439.1	Height(H)	Hex Width(W)	Depth(D)
ISOTP20M6	548420	1,000 VAC, 1,500 VDC	3,500 VAC @ 1 min	20 mm	17 mm	20 mm
ISOTP25M5	548700	1,000 VAC, 1,500 VDC	3,500 VAC @ 1 min	25 mm	19 mm	20 mm
ISOTP25M6	548430	1,000 VAC, 1,500 VDC	3,500 VAC @ 1 min	25 mm	19 mm	20 mm
ISOTP30M6	548440	1,000 VAC, 1,500 VDC	3,500 VAC @ 1 min	30 mm	30 mm	34 mm
ISOTP30M10	548451	1,000 VAC, 1,500 VDC	3,500 VAC @ 1 min	30 mm	30 mm	34 mm
ISOTP30M8	548450	1,000 VAC, 1,500 VDC	3,500 VAC @ 1 min	30 mm	30 mm	34 mm
ISOTP35M6L	548470	1,000 VAC, 1,500 VDC	3,500 VAC @ 1 min	35 mm	41 mm	46 mm
ISOTP35M8	548480	1,000 VAC, 1,500 VDC	3,500 VAC @ 1 min	35 mm	41 mm	46 mm
ISOTP35M10	548490	1,000 VAC, 1,500 VDC	3,500 VAC @ 1 min	35 mm	41 mm	46 mm
ISOTP40M10	548520	1,000 VAC, 1,500 VDC	3,500 VAC @ 1 min	40 mm	46 mm	53 mm
ISOTP40M12	548511	1,000 VAC, 1,500 VDC	3,500 VAC @ 1 min	40 mm	46 mm	53 mm
ISOTP40M6	548500	1,000 VAC, 1,500 VDC	3,500 VAC @ 1 min	40 mm	46 mm	53 mm
ISOTP40M8	548510	1,000 VAC, 1,500 VDC	3,500 VAC @ 1 min	40 mm	46 mm	53 mm
ISOTP45M6	548530	1,000 VAC, 1,500 VDC	3,500 VAC @ 1 min	45 mm	41 mm	47 mm
ISOTP45M10	548560	1,000 VAC, 1,500 VDC	3,500 VAC @ 1 min	45 mm	50 mm	57 mm
ISOTP45M8L	548550	1,000 VAC, 1,500 VDC	3,500 VAC @ 1 min	45 mm	50 mm	57 mm
ISOTP45M8	548540	1,000 VAC, 1,500 VDC	3,500 VAC @ 1 min	45 mm	41 mm	47 mm
ISOTP50M6	548570	1,000 VAC, 1,500 VDC	3,500 VAC @ 1 min	50 mm	50 mm	57 mm
ISOTP50M8	548580	1,000 VAC, 1,500 VDC	3,500 VAC @ 1 min	50 mm	50 mm	57 mm
ISOTP50M12	548581	1,000 VAC, 1,500 VDC	3,500 VAC @ 1 min	50 mm	50 mm	57 mm
ISOTP60M10	548610	1,000 VAC, 1,500 VDC	3,500 VAC @ 1 min	60 mm	55 mm	63 mm
ISOTP60M8	548600	1,000 VAC, 1,500 VDC	3,500 VAC @ 1 min	60 mm	55 mm	63 mm
ISOTP50M10	548590	1,000 VAC, 1,500 VDC	3,500 VAC @ 1 min	50 mm	50 mm	57 mm
ISOTP60M12	548601	1,000 VAC, 1,500 VDC	3,500 VAC @ 1 min	60 mm	55 mm	63 mm
ISOTP60M16	548602	1,000 VAC, 1,500 VDC	3,500 VAC @ 1 min	60 mm	55 mm	63 mm
ISOTP70M16	548630	1,000 VAC, 1,500 VDC	3,500 VAC @ 1 min	70 mm	65 mm	75 mm
ISOTP70M10	548609	1,000 VAC, 1,500 VDC	3,500 VAC @ 1 min	70 mm	65 mm	75 mm
ISOTP75M10	548629	1,000 VAC, 1,500 VDC	3,500 VAC @ 1 min	75 mm	65 mm	75 mm
ISOTP80M16	548670	1,000 VAC, 1,500 VDC	3,500 VAC @ 1 min	80 mm	65 mm	75 mm
ISOTP70M12	548620	1,000 VAC, 1,500 VDC	3,500 VAC @ 1 min	70 mm	65 mm	75 mm
ISOTP75M12	548640	1,000 VAC, 1,500 VDC	3,500 VAC @ 1 min	75 mm	65 mm	75 mm
ISOTP100M12	548680	1,000 VAC, 1,500 VDC	3,500 VAC @ 1 min	100 mm	65 mm	75 mm
ISOTP100M16	548690	1,000 VAC, 1,500 VDC	3,500 VAC @ 1 min	100 mm	65 mm	75 mm
ISOTP80M12	548660	1,000 VAC, 1,500 VDC	3,500 VAC @ 1 min	80 mm	65 mm	75 mm

Table 2/2

Catalog Number	Item Name	Thread Size(TS)	Thread Depth(TD)	Diameter(Ø)	Static Load 1(F1)	Static Load 2(F2)
ISOTP15M4	548400	M4	4 mm	12 mm	1,500 N	1,000 N
ISOTP20M4	548410	M4	4 mm	15 mm	1,500 N	1,000 N
ISOTP20M6	548420	M6	6 mm	15 mm	1,500 N	1,000 N
ISOTP25M5	548700	M5	6 mm	18 mm	3,000 N	1,600 N
ISOTP25M6	548430	M6	6 mm	18 mm	3,000 N	1,600 N
ISOTP30M6	548440	M6	8 mm	26 mm	6,000 N	3,000 N
ISOTP30M10	548451	M10	8 mm	26 mm	6,000 N	3,000 N
ISOTP30M8	548450	M8	8 mm	26 mm	6,000 N	3,000 N
ISOTP35M6L	548470	M6	8 mm	34 mm	11,000 N	5,000 N
ISOTP35M8	548480	M8	8 mm	34 mm	11,000 N	8,000 N
ISOTP35M10	548490	M10	10 mm	34 mm	11,000 N	8,000 N
ISOTP40M10	548520	M10	10 mm	40 mm	11,000 N	4,500 N
ISOTP40M12	548511	M12	14.5 mm	40 mm	11,000 N	4,500 N
ISOTP40M6	548500	M6	9 mm	40 mm	11,000 N	8,000 N
ISOTP40M8	548510	M8	8 mm	40 mm	11,000 N	8,000 N
ISOTP45M6	548530	M6	9 mm	34 mm	11,000 N	6,500 N

Catalog Number	Item Name	Thread Size(TS)	Thread Depth(TD)	Diameter(Ø)	Static Load 1(F1)	Static Load 2(F2)
ISOTP45M10	548560	M10	10 mm	41 mm	18,000 N	7,000 N
ISOTP45M8L	548550	M8	15 mm	41 mm	18,000 N	10,000 N
ISOTP45M8	548540	M8	15 mm	34 mm	11,000 N	6,500 N
ISOTP50M6	548570	M6	9 mm	41 mm	20,000 N	7,000 N
ISOTP50M8	548580	M8	15 mm	41 mm	20,000 N	10,000 N
ISOTP50M12	548581	M12	14.5 mm	41 mm	20,000 N	10,000 N
ISOTP60M10	548610	M10	10 mm	44 mm	22,000 N	10,000 N
ISOTP60M8	548600	M8	15 mm	44 mm	22,000 N	10,000 N
ISOTP50M10	548590	M10	10 mm	41 mm	20,000 N	10,000 N
ISOTP60M12	548601	M12	14.5 mm	44 mm	22,000 N	10,000 N
ISOTP60M16	548602	M16	20 mm	44 mm	22,000 N	10,000 N
ISOTP70M16	548630	M16	20 mm	52 mm	25,000 N	16,000 N
ISOTP70M10	548609	M10	10 mm	52 mm	22,000 N	10,000 N
ISOTP75M10	548629	M10	10 mm	51 mm	22,000 N	10,000 N
ISOTP80M16	548670	M16	20 mm	52 mm	30,000 N	16,000 N
ISOTP70M12	548620	M12	20 mm	52 mm	25,000 N	16,000 N
ISOTP75M12	548640	M12	20 mm	51 mm	30,000 N	16,000 N
ISOTP100M12	548680	M12	20 mm	46 mm	30,000 N	10,000 N
ISOTP100M16	548690	M16	20 mm	46 mm	30,000 N	15,000 N
ISOTP80M12	548660	M12	20 mm	52 mm	30,000 N	16,000 N

## ADDITIONAL PRODUCT DETAILS

Creepage and clearance distances need to be in accordance with the relevant application standard.

## DIAGRAMS

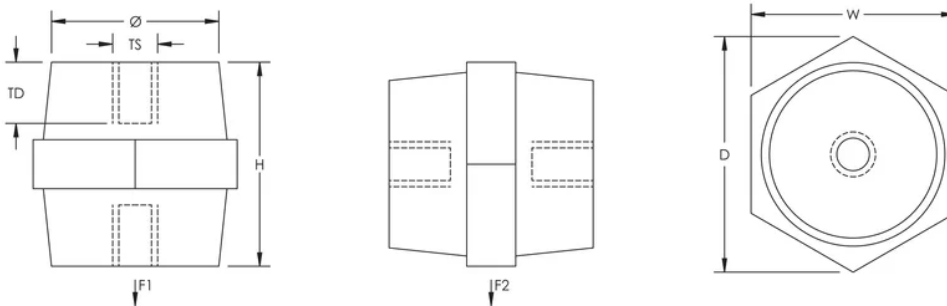

## WARNING

nVent products shall be installed and used only as indicated in nVent's product instruction sheets and training materials. Instruction sheets are available at [www.nvent.com](http://www.nvent.com) and from your nVent customer service representative. Improper installation, misuse, misapplication or other failure to completely follow nVent's instructions and warnings may cause product malfunction, property damage, serious bodily injury and death and/or void your warranty.

**North America**

+1.800.753.9221

Option 1 – Customer Care

Option 2 – Technical Support

**Europe**

Netherlands:

+31 800-0200135

France:

+33 800 901 793

**Europe**

Germany:

800 1890272

Other Countries:

+31 13 5835404

**APAC**

Shanghai:

+ 86 21 2412 1618/19

Sydney:

+61 2 9751 8500



Our powerful portfolio of brands:  
**nVent.com CADDY ERICO HOFFMAN RAYCHEM SCHROFF**  
**TRACER**